

敬文書院
C W Chu College

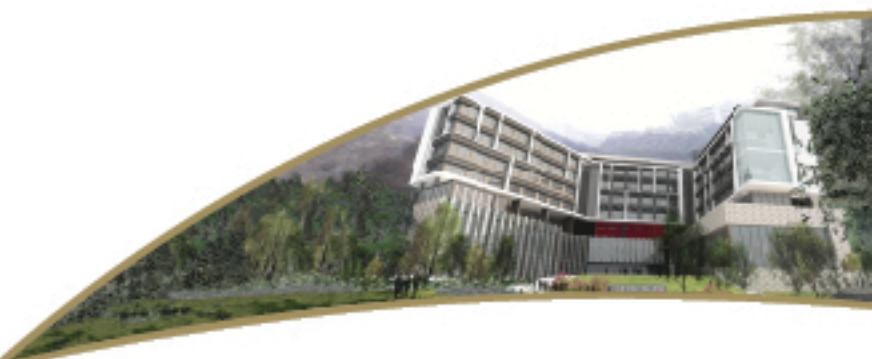

修己
澤人

Cultus et Beneficentia

儲才

濟世

香港中文大學
The Chinese University of Hong Kong



修己澤人 儲才濟世

Cultus et Beneficentia

· 院長獻詞 ·

MESSAGE FROM THE MASTER

修己澤人，儲才濟世

大學在2012-13學年開始實行四年學制，屆時在校本科生人數要增加三分之一。有見及此，並為了進一步發展和加強書院制，香港中文大學成立了五所新書院，敬文書院是其中之一。

敬文書院為小型書院，容納約三百名學生及三十名來自不同院系的教職員。書院提供四年全期住宿，旨在締造親切融和的社群氛圍。我們以博學多才、圓融通達為目標，培育學生，提升其個人素養。

敬文書院的願景，是

匯聚來自不同背景的學者，共建一個親切融和的社群，並以探究真理、慷慨利他的精神，出為世用。

書院願景涵蓋四項元素，彰顯書院特色，引領書院發展。書院屬小型規模，**親切融和**，組成一個緊密團結的社群。成員來自五湖四海、修讀不同學科，一起生活、學習、成長，使同學得以體驗**多元文化**，進而拓展其國際視野。師生**崇尚知識**，以充滿好奇和探究的精神學習及生活。師生珍視學問，立言以立行，**修己澤人**，**投入社群**，貢獻社會。

大學教育着重追尋學科知識，而書院則更關注全人教育，兩者相輔相成。敬文書院以「修己澤人，儲才濟世」為院訓，強調個人承擔、責任和誠信，更鼓勵同學推己及人，服務社群，這些都是先賢朱敬文博士所努力體現的價值觀。書院宏遠的辦學理想，吸引了一群熱心的老師。他們努力不懈，籌辦課程、設計活動、開展交流和服務計劃，並向有志入讀中文大學的中學生推介敬文書院的教育理念。在未來大半年，書院將致力為第一屆新生入學作好準備。

書院建築群於2011年11月奠基，象徵書院教育事業的重要一步。我們景仰朱敬文博士高風亮節，並將秉承先賢風範，啟迪後學心靈。書院期盼有為青年的加入，學成後回饋社會。

各位師生，各位朋友，讓我們為此目標，一同努力，使書院的教育事業開花結果。



敬文書院院長 楊綱凱

2011年11月



Cultus et Beneficentia

CW Chu College is one of the new Colleges of The Chinese University of Hong Kong (CUHK), set up in response to the expected increase in the number of undergraduates; it will start admitting students in the 2012-13 academic year, just as the first cohort enters the new four-year curriculum.

CW Chu College is a small college with a student membership of approximately 300. It will provide residential accommodation for all its undergraduate members for four years of their undergraduate studies. With about 30 teachers from different disciplines at CUHK, CW Chu College will be in an excellent position to cultivate the intellectual and social development of students for their own benefit and for the benefit of the communities they will serve.

Our vision is to foster

An intimate community of scholars drawn from diverse backgrounds, engaged with the world in a spirit of curiosity and generosity.

Four elements distinguish the College. CW Chu College will be *intimate*, small with a personal touch; *international*, with students and teachers drawn from a variety of backgrounds and cherishing cultural diversity and a global outlook; *intellectual* in the approach to learning and life, in a spirit of curiosity and enquiry; and *involved* with the wider community in a spirit of generosity, through service and other contributions.

The accent is on personal responsibility and integrity, and the spirit of service to others; these echo the values which the late Dr CW Chu exemplified, and which are encapsulated in the College motto *Cultus et Beneficentia*. Our vision has drawn teachers, who have worked hard to design educational and pastoral programmes, to plan social, exchange and service activities for students, and to convey our aims to prospective students. Much still needs to be done in the months ahead.

In November 2011, we laid the foundation stone for the College premises, as well as the foundation for the educational enterprise upon which we embark. We look back to the late Dr CW Chu whose shining example has inspired this endeavour, and look forward to the day when teenagers will join our College and emerge ready to contribute to society as young adults. We are conscious of the tradition and values upon which we build, and of the immense potentialities that lie ahead.

I thank all those who have contributed to this endeavour, and call upon those who share in this vision to continue their support as we work to bring the College to fruition.

Kenneth Young
Master, CW Chu College
November 2011



· 香港中文大學及其書院制 ·

THE CHINESE UNIVERSITY OF HONG KONG AND ITS COLLEGE SYSTEM



香港中文大學是研究型綜合大學，下設八個學院，另有研究院和多個研究所和研究中心，負責教學與研究。雖然中大的營運開支主要靠公帑支持，但自創校之初始，本校已接受捐獻饋贈。

位於香港特別行政區沙田的中大校園，依山而建，茂樹蔭蔚，佔地廣達一百三十七公頃。本校以獨特的書院制來安排本科生教育和校園生活，這種書院制承襲歐美著名大學的傳統，在亞洲頂尖大學中獨樹一幟。中大現有九所書院，各有自己的特色和背景。

中大所有書院均設有宿舍和食堂，敬文書院（和其他兩所書院）能為全體院生提供四年住宿。在中大學生的求學生涯中，書院生活是不可或缺的一環：大學致力在各學科提供最高水準的專科教育，培育專才，書院則為學生提供全人教育，使他們在踏出校門時，能夠準備就緒，從容應付學院外的生活和挑戰，進而貢獻社會。書院生活涵蓋各式各樣的學術和社交活動，還有個人輔導，務求使每位學生都能在導師和學長的幫助下有所進益，投入社群生活，發展一己所長。

The Chinese University of Hong Kong is a comprehensive research-led university with teaching and research carried out within its eight Faculties, its Graduate School and various research institutes and centres. While the University operates chiefly on public funding, it has, since its very early days, been a recipient of donations and endowments from benefactors.

The campus of The Chinese University of Hong Kong occupies some 137 hectares spread over wooded hillocks just outside Shatin in the Hong Kong Special Administrative Region, China. Undergraduate teaching and campus life are organized through a distinct college system in the tradition of distinguished collegiate universities in Europe and America and unique among leading Asian universities. The University currently has nine Colleges, each with its unique characteristics and background.

All the Colleges at The Chinese University of Hong Kong are residential and offer dining facilities; CW Chu College is one of three that offer residential accommodation for all its undergraduate members throughout their studies. The Colleges are an integral and important part of student life at the University: the University aims to educate, to the highest academic and professional standard, each student in a chosen academic discipline; at the same time a holistic education is provided so that students may graduate fully prepared for the life and challenges in society, and are equipped with the moral, ethical and social attributes that would enable them to contribute to society in significant ways. College life thus encompasses a full range of academic and social activities as well as student-oriented tutorials, so that every student may benefit from both communal life and individual attention from teachers and mentors.

· 敬文書院 ·

CW CHU COLLEGE



源起

香港中文大學為配合2012年恢復本科四年制，成立了五所新書院，敬文書院是其中之一。書院以朱敬文博士命名。朱博士（1906–1996）大半生在香港奮鬥發展，事業有成後，慷慨無私、捐助教育，扶掖後進、不遺餘力。大學特以他的芳名為書院命名，以紀念其行誼事業。

大學的一員

院訓「修己澤人，儲才濟世」，充分體現書院的使命，即令書院學生在四年書院生活中接受全人教育，拓寬眼界，學習成為社會上負責任和積極投入的一員。盾形院徽刻有以篆體寫成的書院名稱，其下有拉丁文和中文院訓。

儘管敬文書院成立不久，但在多方面已建立自己的特色，與校內其他書院有不同的定位。這所小型書院可容納約三百名學生，是大學三所能提供全期住宿的書院之一，全體院生在大學四年之中全宿共膳。這種傳統，歷史悠久，備受珍惜。西方的書院式大學，名最著者牛津、劍橋，皆行此制。敬文書院將致力加強書院師生間的交流，提高學生對切磋學問、討論知識的興趣，以廣其胸襟，博其知識，陶鑄其品德，並授之以立足社會不可或缺的人際交往技巧。得此訓練的學生，畢業後自然能長於領導統馭，熱心服務社會，並且思維澄明、直內方外。

Origin

CW Chu College is one of the Colleges established by The Chinese University of Hong Kong in anticipation of the reversion to a four-year undergraduate curriculum and increased student numbers in 2012. The College is named after Dr Chu Ching-wen (1906–1996), a prominent industrialist and a remarkable philanthropist who spent the larger part of his career in Hong Kong. The University decided to perpetuate the memory of Dr Chu by naming one of the new Colleges after him.

A new College within the University

The motto of the College, *Cultus et Beneficentia*, translates as cultivating oneself and benefitting the community. It is echoed by the Chinese motto 「修己澤人，儲才濟世」, and eloquently expresses the mission of the College, namely, that the students therein may receive a holistic education, and through the experience of four years of college life, may broaden their outlook and learn to be responsible and committed members of society. The motto is inscribed in both Latin and Chinese on the College Crest, which shows the name of the College in seal script on a shield.

Newly founded, CW Chu College will distinguish itself among other Colleges at The Chinese University of Hong Kong in a number of ways. It is a small college with a student membership of about 300, and is one of only three Colleges that are fully residential, with all students living in the College during their undergraduate studies. Communal dining in the College is also an expectation. These features hark back to the long and cherished tradition of collegiate institutions in the West, Oxford and Cambridge being the best-known examples. We will substantially strengthen the interaction between academics and students, raise the students' interest in intellectual dialogue, enhance their scope and depth of general knowledge, broaden their perspective on the world at large, enhance in them a capacity for ethical reflection and conduct, and furnish them with the interpersonal skills that will stand them in good stead in life after graduation. CW Chu College aims to produce graduates who are honed for leadership, service, intellectual clarity and ethical conduct.

院址與建築

敬文書院校舍坐落於環迴北路，將與附近將陸續興建的研究大樓和研究生設施組成一群，並融合於四周草木蔥蘢的自然環境。除學生宿舍外，還有可供全體書院成員用膳的設施，以及供舉行導修課、研討會和其他書院活動的多用途場地。

The Site and the Fabrics

CW Chu College is situated at the Campus Circuit North, within a cluster of development that will also include postgraduate and research facilities. The College buildings will blend in with the lush and green surroundings. Apart from living quarters for the undergraduates, the buildings will house dining facilities for the entire membership of the College, and purpose-built space for tutorials, seminars and other collegiate activities.





· 朱敬文博士 ·

中文大學的新書院得名自朱敬文博士，朱博士（1906–1996）生於江蘇省揚州江都七里鄉朱套村，畢生行義，在香港和內地捐資助學，支持年青學子升讀大學，其善舉為人稱道。在1960年至1980年期間，朱博士設立獎學金，資助香港年輕人赴美深造，人數逾七百名。及至八十年代末期，他把助學的範圍擴展至中國內地，成立朱敬文教育基金，幫助國內大學生，尤其重視江蘇和安徽兩省，受惠者眾，達三萬之數。及後，朱博士長子朱恩餘先生出掌朱敬文教育基金，繼續此項樂善好施、熱心公益的義舉。

歷來鼎力支持教育的慈善家不獨朱敬文博士一人，但朱博士與眾不同並最為人敬重和緬懷之處是，他不僅不吝巨資，還不辭勞苦，親自照料和探望受助學子，關注彼等之學業和成長，關愛之情猶如慈父。

· 朱氏學人 ·

朱敬文博士興教助學的善舉現在碩果纍纍。當年得蒙朱博士資助負笈美國的年輕學子，今天都在各行各業卓然有成，成為社會的中流砥柱。這些朱氏學人彼此以「朱仔」相稱，並以朱博士為楷模，繼承他不求聞達、無私奉獻的精神，攜手行善濟世，造福社會。遍布世界各地的朱氏學人，將會成為敬文書院學生的學長。

DR CHU CHING-WEN

Dr Chu Ching-wen (1906–1996), in whose honour the College is named, was born in Jiangsu in 1906. His philanthropic legacy is continued through the CW Chu Foundation, which is chaired by Dr Chu's eldest son, Mr David Chu.

Amidst the many charitable endeavours he undertook during his lifetime, Dr CW Chu is most revered for his extensive work in support of higher education for young people, first in Hong Kong and then later in mainland China. During the 1960s to the 1980s, Dr Chu provided scholarships that enabled more than 700 young people from Hong Kong to pursue higher education in the United States. From the late 1980s onwards, Dr Chu transferred his aid scheme to the mainland where, through the CW Chu Foundation, support has been provided to university students, especially in Jiangsu and Anhui. To this day, over 30,000 mainland university students have benefitted from the munificence of the Foundation.

Quite unlike other philanthropists who also focus their attention on education, Dr CW Chu is remembered and venerated nowadays not only for the substantial funds he provided, but also for his personal interest and involvement in their studies, their progress and their development, fulfilling a venerated paternal role in *loco parentis*.



THE CHU SCHOLARS

The philanthropic efforts of the late Dr CW Chu have borne wonderful fruit. The students whom he sponsored for university education in the United States have now distinguished themselves in various industries and professions. The Chu Scholars, who fondly refer to each other as “Children of Chu” (「朱仔」), have acted together in many charitable undertakings, following the worthy example of Dr Chu in being a selfless contributing member of the community. Students of CW Chu College will benefit from the network of mentors formed by Chu Scholars all over the world.

歡迎青年學子加入書院，歡迎有志同人參與籌建工作，更歡迎認同我們理念的各界人士鼎力支持！

Whether you are interested in CW Chu College as a potential supporter, a student member, or a friend willing to help with our mission, we look forward to welcoming you into the CW Chu family!



Contact us 聯絡我們

☎ (852) 3943 1801

☎ (852) 3943 1802

✉ info.cwchu@cuhk.edu.hk

🌐 www.cuhk.edu.hk/cwchu

📘 facebook.com/cuhkcwc

